

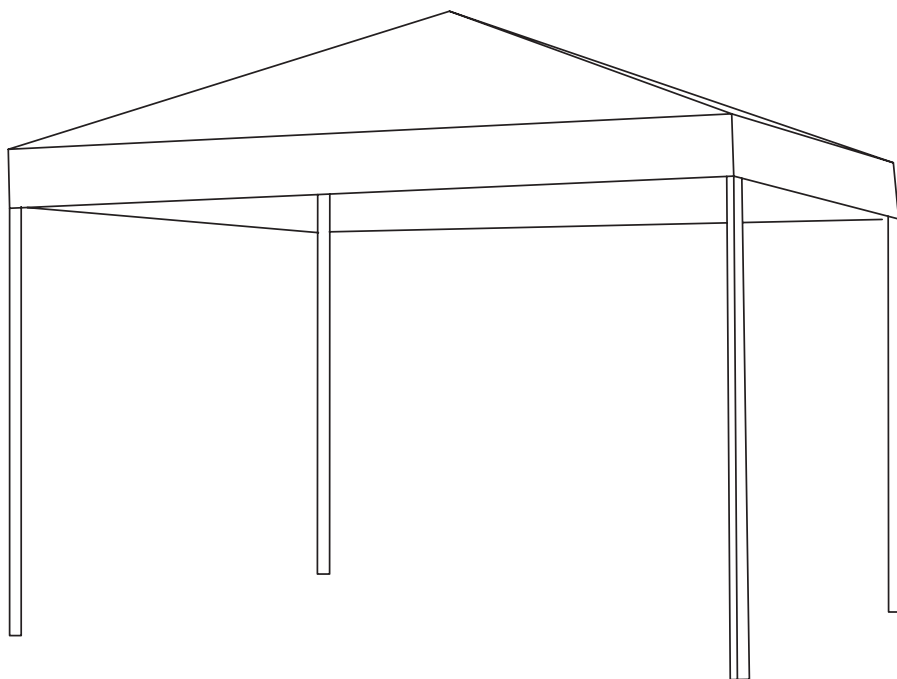

RBG040

Gazebo 3x3m



INSTRUCTION MANUAL

CONTENTS

1x Tent Frame



1x Tent Top



8x Stakes



4x Guylines

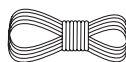

1x Carry Bag

OPENING STEPS

1

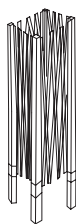

2

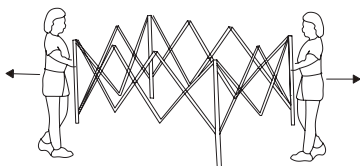

3

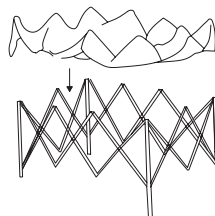

4

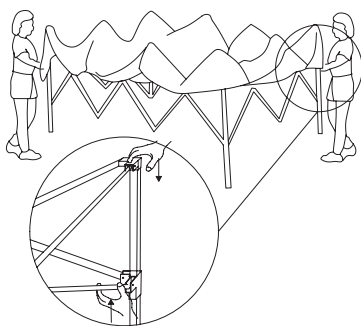

5

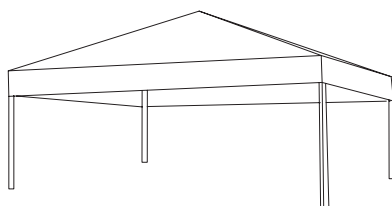

6

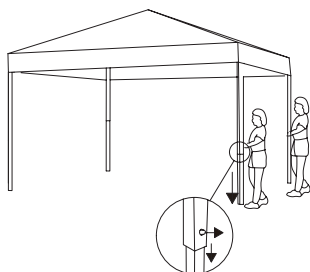

7

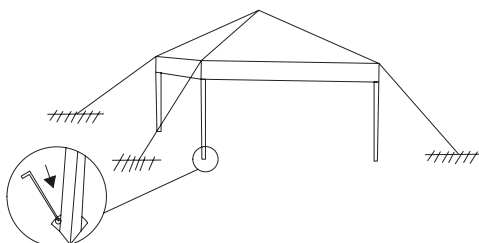

CLOSING STEPS

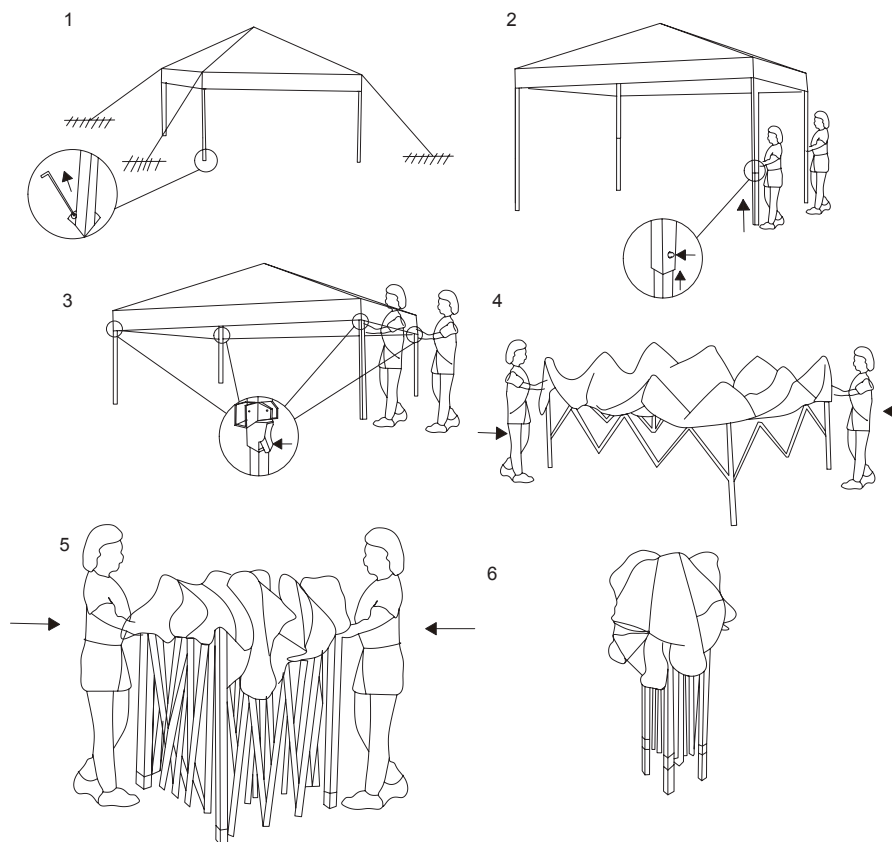

2 persons are needed to hold 4 corners of the tent, gently shake to slightly spread the cross pole of the tent frame.

1. Remove all contents from the bag and place out on dry flat even surface.
2. Begin by opening the frame of the gazebo by lifting and pulling from opposite corners.
3. Once the frame is half open proceed to place awning covering over the top.
4. Secure awning with the straps and ensure frame clips and locked into place. you can then continue to extend frame to the fully open position.
5. Once the frame has been constructed you can then place into position.
6. You can also now adjust the legs to the appropriate height of your choosing.
7. Secure the gazebo with guy wires to pegs or use weight bags/bricks accordingly.

WARNING

- Assembly should be performed by two people as doing so alone could put unnecessary stress on the legs, this could cause unnecessary damage if not pulled apart in tandem. Be aware of pinch points.
- The tent should be secured in windy or adverse weather conditions by using the ropes and peg stakes provided. Each side of the canopy has securing points to attach the ropes to the ground.
- Stakes should be hammered in at 30 degrees inwards towards the tent for best results.
- If the tent will be used on hard surface it is recommended to have all four sides weighed down with either bricks or sandbags.
- Do NOT assemble or leave assembled canopy in adverse weather conditions (e.g. rain, wind, snow ...) this will damage the canopy and may pose a risk and hazard to others and property. It is the owners responsibility to use and maintain the canopy without causing injury or damage to others.

WARRANTY INFORMATION

Our product is guaranteed to be free from manufacturing defects for a period of 12 Months. If your product becomes defective during this period, Electus Distribution will repair, replace, or refund where a product is faulty; or not fit for intended purpose. This warranty will not cover modified product; misuse or abuse of the product contrary to user instructions or packaging label; change of mind and normal wear and tear.

Our goods come with guarantees that cannot be excluded under the Australian Consumer Law. You are entitled to a replacement or refund for a major failure and for compensation for any other reasonably foreseeable loss or damage. You are also entitled to have the goods repaired or replaced if the goods fail to be of acceptable quality and failure does not amount to a major failure.

To claim warranty, please contact the place of purchase. You will need to show receipt or other proof of purchase. Additional information may be required to process your claim.

Any expenses relating to the return of your product to the store will normally have to be paid by you. The benefits to the customer given by this warranty are in addition to other rights and remedies of the Australian Consumer Law in relation to the goods or services to which this warranty relates.

This warranty is provided by: Electus Distribution
Address 46 Eastern Creek Drive, Eastern Creek NSW 2766 Ph. 1300 738 555