

# Binoculars

## with Screen and Live Camera



Model:  
**MNC018**



Please read and save all instructions to ensure safe and effective use of this product.

# Instruction Manual

## PRODUCT OVERVIEW

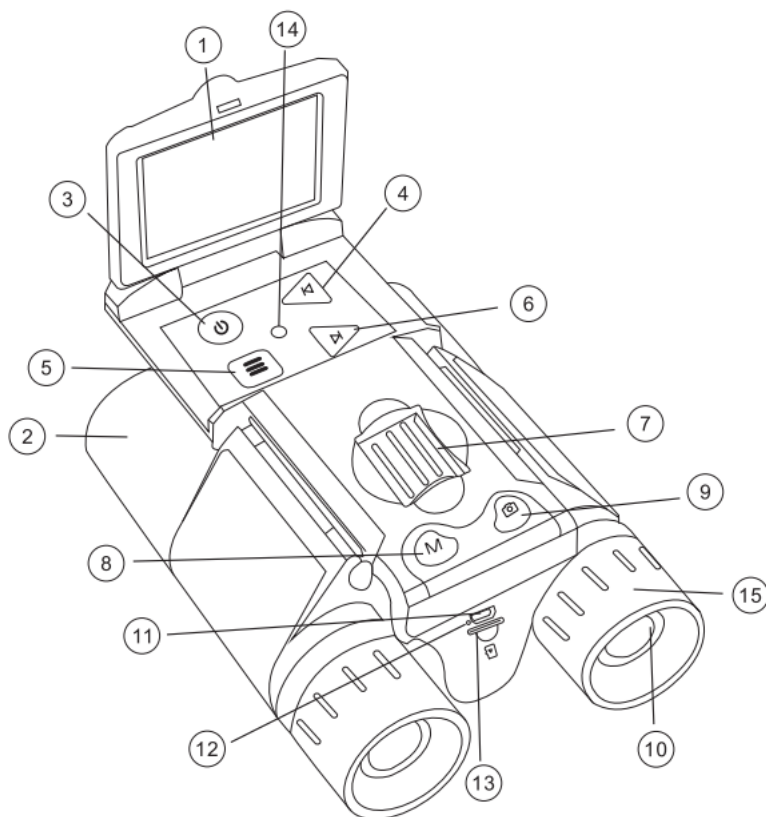

- |                 |                     |
|-----------------|---------------------|
| 1. LCD Screen   | 9. Camera/OK Button |
| 2. Optical lens | 10. Eyepiece        |
| 3. Power on/off | 11. Type-C USB Port |
| 4. Left Button  | 12. LED indicator   |
| 5. Menu Button  | 13. Micro SD Slot   |
| 6. Right Button | 14. Reset           |
| 7. Focus ring   | 15. Diopter Ring    |
| 8. Mode Button  |                     |

## OPERATING INSTRUCTIONS

### How to use the binoculars

You can use binoculars like any other pair of binoculars. Place your eyes correctly against the rubber, adjust the spacing of the 2 vision tubes and use the dial located above to focus. You can also turn the dial directly on the right side viewfinder at the level of the rubber where you place your eyes.

### How to use the digital recording camera

#### 1. Charging the battery

Connect to the camera to the AC adaptor, using the dedicated USB cable supplied. The camera can be charged by connecting the camera to a computer using the dedicated USB cable.

\*Charging indicator: red light-charging, red light Off -fully charged.

#### 2. Inserting a memory card

Insert the Micro SD card into the Micro SD card slot.

#### Select the mode

When the blue LED of the binocular is lit, press the Mode button (8) to switch between: Video; Photo; Replay

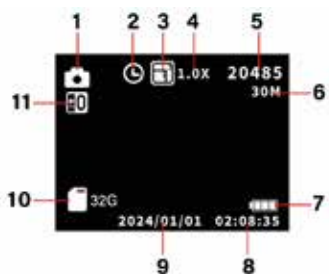

- |                            |                        |
|----------------------------|------------------------|
| 1. Photo Mode              | 7. Battery Level       |
| 2. Self Timer              | 8. Current Time        |
| 3. Photo Burst             | 9. Current Date        |
| 4. Zoom level              | 10. Memory Card Loaded |
| 5. Photos Remaining        | 11. Exposure Value     |
| 6. Photo Size (Resolution) |                        |

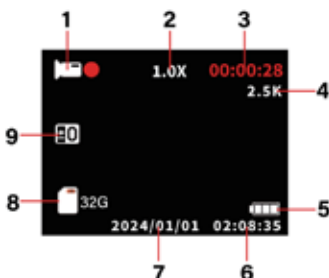

- |                            |                       |
|----------------------------|-----------------------|
| 1. Video Mode              | 5. Battery Level      |
| 2. Zoom level              | 6. Current Time       |
| 3. Recording Time Elapsed  | 7. Current Date       |
| 4. Video Size (Resolution) | 8. Memory Card Loaded |
|                            | 9. Exposure Value     |

- **In video mode:** Press the camera button (9) to start shooting. Press again to stop filming.
- **In photo mode:** Press the camera button (9) to take a picture. Press as many times as you want to take a photo.
- **In replay mode** use the Left (4) and Right (6) buttons to select the file you want to watch and press the Camera button (9) to play a video on the screen.

**Note:** For best picture quality, hold the binoculars firmly or use a tripod to stabilize during recording.

### 3. Turn off the Binocular

Press and hold the Power button (3) until the screen off.

### 4. Video settings

Turn on the binoculars, press the Menu button (5) and then use the Left (4) and Right (6) buttons to navigate the resolution menu. Press the Camera button (9) to enter the sub-menus and set the video resolution, press Camera Button to confirm your choices and exit settings, press the Menu button or Mode button to return to the normal screen:

Video Size: 2.5K UHD / 1080P FHD / 1080P / 720P  
 Loop Recording: Off / 1 / 2 / 3 / 5 Minute  
 Video Rate: Normal / Slow / Fast  
 Time Stamp: On / Off

### 5. Photo settings

Turn on the binoculars, and select the photo mode.

Press the Menu button (5) and then use the Left (4) and Right (6) buttons to navigate the Photo menu. Press the Camera button (9) to enter the sub-menus and confirm your choices and exit settings, press the Menu or Mode button (8) to return to the normal screen:

Photo Size: 48M / 30M / 25M / 20M / 10M / 8M / 5M / 3M  
 Self Timer: Off / 2 / 5 / 10 Seconds  
 Photo Burst: Off / 3 Photos

### 6. Replay settings

Turn on the binoculars, and select the replay mode.

Press the Mode button (8) to enter reply mode and then use the Left(4) or Right (6) buttons to navigate the photo or video file. Press the camera button (9) to replay the video, press the Menu button (5) and camera button (9) to delete the file, press Mode button to return normal screen:

Delete > Delete Current / Delete All > Cancel / OK

## 7. Exposure Settings

This function can be automatically set to EVA when the light is sufficient. In low light conditions, EV can be adjusted from +2 to - 2, then adjust the peripheral light of the photographed object to achieve the clearest state.

Turn on the binoculars, in Video or photo mode, press Menu button (8), use Left (4) or Right (6) buttons to navigate to exposure setting project, press Camera button (9) to enter exposure setting submenu. set exposure value using Left (4) or Right (6) buttons, press camera button (9) to confirm setting and exit.

Exposure Value Setting:    +2.0,+5/3,+4/3,+1.0,+2/3, +1/3,+0.0,-1/3,-2/3,-1.0,  
   -4/3,-5/3,-2.0

## 8. System settings

Turn on the binoculars and press the Menu button (5) to open setting menu and then use the Left (4) or Right (6) button to navigate the menu. Press the camera button (9) to enter the sub-menus and confirm your choices. To exit settings, press the Menu button (5) or Mode button (8) to return to the normal screen:

Screen Brightness:    1 2 3 4 5 6 7 8 level  
Screen Saver:           Off; 1 Minute; 2 Minutes; 3 Minutes  
Auto Power-Off:       Off; 1 Minute; 3 Minutes; 5 Minutes  
Language:              English, Japanese, French, Spanish, Portuguese, German,  
                                 Korean, Italian, Chinese, Russian, Arabic  
Volume:                0 1 2 3 4 5 6 7 8 Level  
Format Card:           Cancel / Format  
Date/Time Set:        Year/Month/Day  
                                 Hour: minute: second  
Restore Default:       Cancel / OK

## Connect to the PC

Connect the camera to PC by using USB cable and turn on the camera, the PC can read the files in this camera.

## 9. Reset

When the product stops responding due to misuse or other unknown reasons and cannot be connected to a computer, please reset it by pressing the “Reset” button (14). The product stops and resets.

The recorded files on the MicroSD are not affected. Even the done settings are not influenced.

## CARE & MAINTENANCE

- Clean the product only with a dry or slightly damp, lint-free cloth.
- Do not use abrasive cleaners to clean the unit.
- Digital binocular is a high-precision optical instrument, so in order to avoid damage, please avoid the following practice:
  - Use the binocular in ultra-high or ultra-low temperature.
  - Keep it or use it in moist environment for long.
  - Use it in rainfalls or in water.
  - Deliver or use it in strongly shocking environment.

## SPECIFICATIONS

<b>Magnification (X)</b>	10
<b>Effective diameter of objective lens(mm)</b>	25
<b>Angular field of view (real) (°)</b>	5.8
<b>Field of view at 1000m (m)</b>	101M/1000M
<b>Exit pupil (mm)</b>	2.5
<b>Eye relief (mm)</b>	10
<b>Close focusing distance (m)</b>	6
<b>Interpupillary distance adjustment (mm)</b>	55-75
<b>Digital Zoom</b>	8X
<b>Photo resolution</b>	48M, 30M, 25M, 20M,10M, 8M, 5M, 3M
<b>Video resolution</b>	2.5K UHD,1080FHD,1080P,720P
<b>Screen</b>	2.0 inches IPS Screen
<b>Language</b>	English, Japanese, French, Spanish, Portuguese, German, Korean, Italian, Chinese, Russian, Arabic
<b>Memory</b>	Micro SD card, max to 128 GB (not included)
<b>Port</b>	Type-C USB port
<b>Battery</b>	Built-in Rechargeable Lithium Polymer battery 1000mAh

## WARRANTY INFORMATION

Our product is guaranteed to be free from manufacturing defects for a period of 12 Months.

If your product becomes defective during this period, Electus Distribution will repair, replace, or refund where a product is faulty; or not fit for intended purpose.

This warranty will not cover modified product; misuse or abuse of the product contrary to user instructions or packaging label; change of mind and normal wear and tear.

Our goods come with guarantees that cannot be excluded under the Australian Consumer Law.

You are entitled to a replacement or refund for a major failure and for compensation for any other reasonably foreseeable loss or damage. You are also entitled to have the goods repaired or replaced if the goods fail to be of acceptable quality and failure does not amount to a major failure.

To claim warranty, please contact the place of purchase. You will need to show receipt or other proof of purchase. Additional information may be required to process your claim.

Any expenses relating to the return of your product to the store will normally have to be paid by you.

The benefits to the customer given by this warranty are in addition to other rights and remedies of the Australian Consumer Law in relation to the goods or services to which this warranty relates.

This warranty is provided by:

Electus Distribution

Address 46 Eastern Creek Drive, Eastern Creek NSW 2766

Ph. 1300 738 555