



AA2117



OWS EARBUDS WITH BUILT-IN AI TRANSLATION

USER MANUAL



R-NZ

Earphones Parameters (configuration a little bit different with different models)

Earphone Battery Capacity: 50mAh x 2	Transmission range: 2402-2480MHz
Charging case battery capacity: 400mAh	Supported protocol: HSP/HFP/A2DP/AVRCP
Frequency response range: 20HZ-20KHZ	Transmission frequency: 2.4GHz
Product impedance :16Ω±15%	Charging time: about 1.5 hours
Sensitivity: 118dB+/-3@1kHz	Call time: About 6 hours
Size: 49.48*33.6*13.5mm (without charging case)	Music time: about 8 hours (50% volume)
Working distance: 10m (standard environment)	Charging voltage/current: 5V/ 1A
Weight: 68g (without storage box)	Product operating temperature: -10°C~+45°C
Bluetooth version: V5.4	Product storage temperature: -20°C~+65°C



150 Languages Translation 98% Accuracy



Phone Calls



Music Playing

VTrans download and instructions for use

- Please scan the QR code with your mobile phone or tablet to download and install VTrans



- Open the APP, click "Connect" on the right side to enter the Bluetooth settings of the phone, and find your bluetooth and pair it, and then return to the VTrans main interface after paired. (Please ignore this step if you have connected this earphones before)
- VTrans provides three translation modes with different application scenarios

- A: Simultaneous Mode** (one person wears one earphone): Select the language, click the start talking button. The device will automatically recognize the language of both parties, and broadcast it after translation.
- B: Speaker Mode** (mobile phone to earphone): First, set the corresponding

language, double-click the earphone touch area and speak, and the mobile phone displays the translation result and broadcasts it; Tap the phone to start talking, The headphones broadcast the translation result.

- C: Touch mode** (one person wears one earphone), both parties wear headphones, and select the corresponding language. Double-click the touch area of the earphone to start speaking, and the voice will be automatically recognized after the end, and the headset will broadcast the translation result
4. "My" module:
- Set the system language
 - Operation instructions of the APP
 - Basic settings and function selection

Operation Instruction

Power on

- Open the charging case, and the earphones will turn on automatically
- Touch for 3 seconds to power on

IOS and Android systems connect the earphones

Turn on the Bluetooth of the mobile phone, search for the Bluetooth device (FLOW OT05-1). For the first time, you need to manually connect the device.

Power Off

- Put in the charging case and close cover to shut down
- Press and hold for 6 seconds to turn off
- Power on for 3 minutes without connection, and

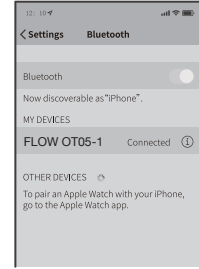

language, double-click the earphone touch area and speak, and the mobile phone displays the translation result and broadcasts it; Tap the phone to start talking, The headphones broadcast the translation result.

- C: Touch mode** (one person wears one earphone), both parties wear headphones, and select the corresponding language. Double-click the touch area of the earphone to start speaking, and the voice will be automatically recognized after the end, and the headset will broadcast the translation result
4. "My" module:
- Set the system language
 - Operation instructions of the APP
 - Basic settings and function selection

Operation Instruction

Power on

- Open the charging case, and the earphones will turn on automatically
- Touch for 3 seconds to power on

IOS and Android systems connect the earphones

Turn on the Bluetooth of the mobile phone, search for the Bluetooth device (FLOW OT05-1). For the first time, you need to manually connect the device.

Power Off

- Put in the charging case and close cover to shut down
- Press and hold for 6 seconds to turn off
- Power on for 3 minutes without connection, and

language, double-click the earphone touch area and speak, and the mobile phone displays the translation result and broadcasts it; Tap the phone to start talking, The headphones broadcast the translation result.

- C: Touch mode** (one person wears one earphone), both parties wear headphones, and select the corresponding language. Double-click the touch area of the earphone to start speaking, and the voice will be automatically recognized after the end, and the headset will broadcast the translation result
4. "My" module:
- Set the system language
 - Operation instructions of the APP
 - Basic settings and function selection

Operation Instruction

Power on

- Open the charging case, and the earphones will turn on automatically
- Touch for 3 seconds to power on

IOS and Android systems connect the earphones

Turn on the Bluetooth of the mobile phone, search for the Bluetooth device (FLOW OT05-1). For the first time, you need to manually connect the device.

Power Off

- Put in the charging case and close cover to shut down
- Press and hold for 6 seconds to turn off
- Power on for 3 minutes without connection, and

language, double-click the earphone touch area and speak, and the mobile phone displays the translation result and broadcasts it; Tap the phone to start talking, The headphones broadcast the translation result.

- C: Touch mode** (one person wears one earphone), both parties wear headphones, and select the corresponding language. Double-click the touch area of the earphone to start speaking, and the voice will be automatically recognized after the end, and the headset will broadcast the translation result
4. "My" module:
- Set the system language
 - Operation instructions of the APP
 - Basic settings and function selection

Operation Instruction

Power on

- Open the charging case, and the earphones will turn on automatically
- Touch for 3 seconds to power on

IOS and Android systems connect the earphones

Turn on the Bluetooth of the mobile phone, search for the Bluetooth device (FLOW OT05-1). For the first time, you need to manually connect the device.

Power Off

- Put in the charging case and close cover to shut down
- Press and hold for 6 seconds to turn off
- Power on for 3 minutes without connection, and

language, double-click the earphone touch area and speak, and the mobile phone displays the translation result and broadcasts it; Tap the phone to start talking, The headphones broadcast the translation result.

- C: Touch mode** (one person wears one earphone), both parties wear headphones, and select the corresponding language. Double-click the touch area of the earphone to start speaking, and the voice will be automatically recognized after the end, and the headset will broadcast the translation result
4. "My" module:
- Set the system language
 - Operation instructions of the APP
 - Basic settings and function selection

Operation Instruction

Power on

- Open the charging case, and the earphones will turn on automatically
- Touch for 3 seconds to power on

IOS and Android systems connect the earphones

Turn on the Bluetooth of the mobile phone, search for the Bluetooth device (FLOW OT05-1). For the first time, you need to manually connect the device.

Power Off

- Put in the charging case and close cover to shut down
- Press and hold for 6 seconds to turn off
- Power on for 3 minutes without connection, and

language, double-click the earphone touch area and speak, and the mobile phone displays the translation result and broadcasts it; Tap the phone to start talking, The headphones broadcast the translation result.

- C: Touch mode** (one person wears one earphone), both parties wear headphones, and select the corresponding language. Double-click the touch area of the earphone to start speaking, and the voice will be automatically recognized after the end, and the headset will broadcast the translation result
4. "My" module:
- Set the system language
 - Operation instructions of the APP
 - Basic settings and function selection

Operation Instruction

Power on

- Open the charging case, and the earphones will turn on automatically
- Touch for 3 seconds to power on

IOS and Android systems connect the earphones

Turn on the Bluetooth of the mobile phone, search for the Bluetooth device (FLOW OT05-1). For the first time, you need to manually connect the device.

Power Off

- Put in the charging case and close cover to shut down
- Press and hold for 6 seconds to turn off
- Power on for 3 minutes without connection, and

language, double-click the earphone touch area and speak, and the mobile phone displays the translation result and broadcasts it; Tap the phone to start talking, The headphones broadcast the translation result.

- C: Touch mode** (one person wears one earphone), both parties wear headphones, and select the corresponding language. Double-click the touch area of the earphone to start speaking, and the voice will be automatically recognized after the end, and the headset will broadcast the translation result
4. "My" module:
- Set the system language
 - Operation instructions of the APP
 - Basic settings and function selection

Operation Instruction

Power on

- Open the charging case, and the earphones will turn on automatically
- Touch for 3 seconds to power on

IOS and Android systems connect the earphones

Turn on the Bluetooth of the mobile phone, search for the Bluetooth device (FLOW OT05-1). For the first time, you need to manually connect the device.

Power Off

- Put in the charging case and close cover to shut down
- Press and hold for 6 seconds to turn off
- Power on for 3 minutes without connection, and

Factory reset

Put the earphones into the charging case and keep the case open, hold the left/right earphones touch area for 8 seconds. The Orange light will flash for 3 seconds and then factory reset

Safety Guidelines

- Please follow the instructions in this manual, do not disassemble or modify the device for any reason, otherwise it may cause the earphones to malfunction or burn
- Do not infiltrate the product into any liquid or water to rinse the product
- Do not use a charger other than the rated current and voltage of the headset (5V/1A) to charge the headset, otherwise It is easy to cause damage to the earphones battery (please use the matching charging cable to charge the earphones)
- Please use and store this product in a normal temperature environment, do not place the device in an environment where the temperature is too low or too high (below 0 or above 45°)
- Do not block the openings of the headset, such as the charging port, indicator light and microphone, etc
- Please avoid using headphones at excessive volume or for too long to avoid dizziness or damage to hearing
- Do not use the device under thunderstorm weather, which may cause the device to work abnormally and the signal to be interrupted.

Warranty Information

Our product is guaranteed to be free from manufacturing defects for a period of 12 Months. If your product becomes defective during this period, Electus Distribution will repair, replace, or refund where a product is faulty; or not fit for intended purpose. This warranty will not cover modified product; misuse or abuse of the product contrary to user instructions or packaging label; change of mind and normal wear and tear. Our goods come with guarantees that cannot be excluded under the Australian Consumer Law. You are entitled to a replacement or refund for a major failure and for compensation for any other reasonably foreseeable loss or damage. You are also entitled to have the goods repaired or replaced if the goods fail to be of acceptable quality and failure does not amount to a major failure. To claim warranty, please contact the place of purchase. You will need to show receipt or other proof of purchase. Additional information may be required to process your claim. Any expenses relating to the return of your product to the store will normally have to be paid by you. The benefits to the customer given by this warranty are in addition to other rights and remedies of the Australian Consumer Law in relation to the goods or services to which this warranty relates.

This warranty is provided by:
Electus Distribution
Address 46 Eastern Creek Drive, Eastern Creek NSW 2766
Ph. 1300 738 555